



Dashboard

Component Removal/Installation

SRS wire harnesses are routed near the steering column and the passenger's side of the dashboard.

CAUTION:

- All SRS wiring harnesses are covered with yellow outer insulation.
- Before disconnecting any part of the SRS wire harness, install the short connectors (see page 23-371).
- Replace the entire affected SRS harness assembly if it has an open circuit or damaged wiring.

NOTE: Take care not to scratch the dashboard and steering column.

CAUTION: When prying with a flat tip screwdriver, wrap it with protective tape to prevent damage.

Disassemble in the numbered sequence.

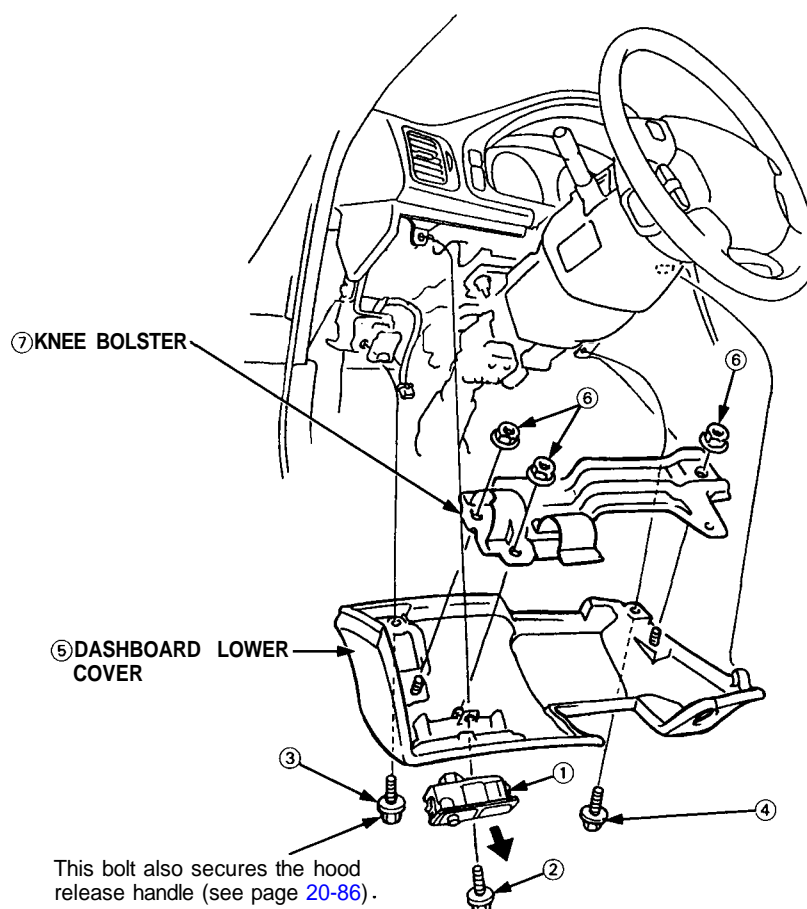
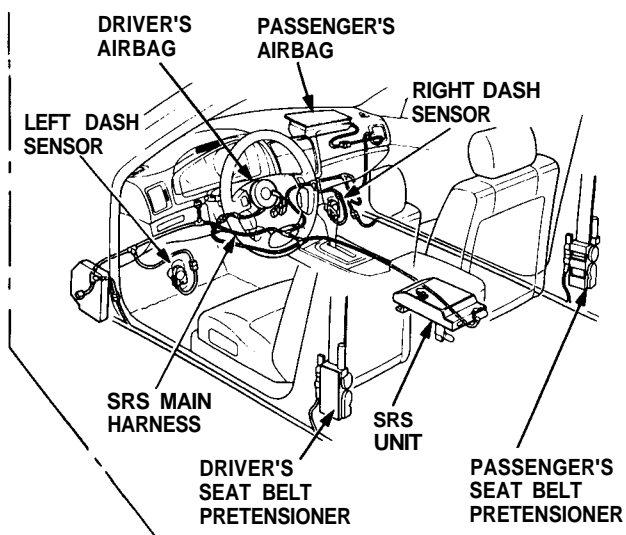

(cont'd)

Dashboard

Component Removal/Installation (cont'd)

INSTRUMENT PANEL

First remove the dashboard lower cover (see page 20-77).

REAR WINDOW DEFOGGER SWITCH

PANEL BRIGHTNESS CONTROLLER

INSIDE HOOKS

CRUISE CONTROL MASTER SWITCH / MOONROOF SWITCH

CENTER AIR VENT/CLIMATE CONTROL UNIT

First remove the:

- Center console panel (see page 20-75)
- Stereo radio/cassette (see page 20-76)

NOTE: Remove the center air vent/climate control unit as an assembly.

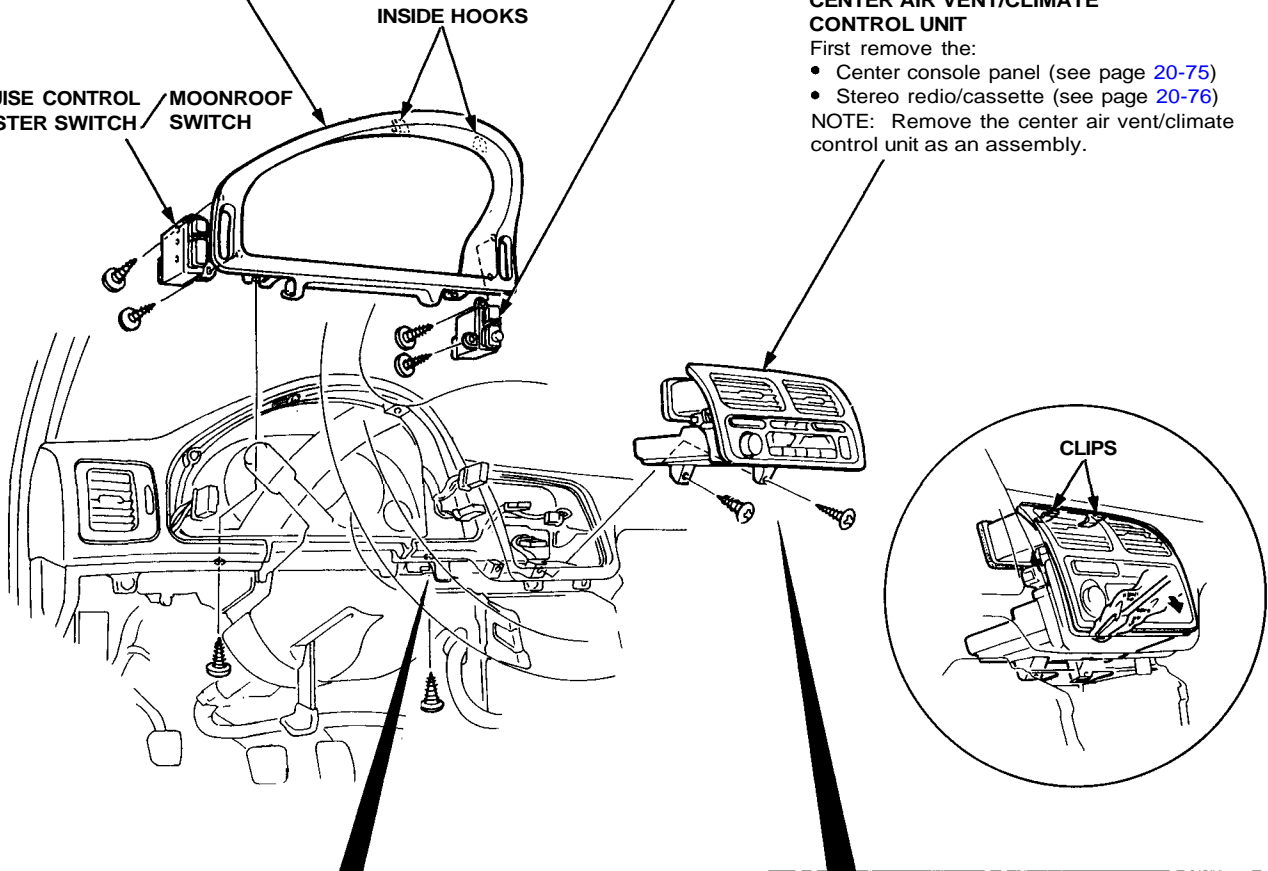

INSTRUMENT PANEL

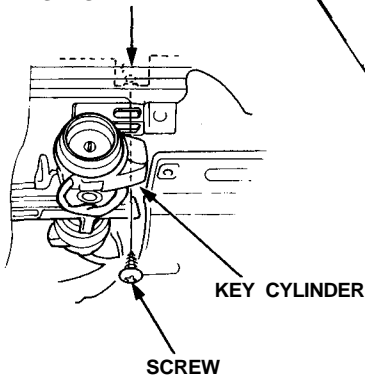

To separate the climate control unit, and center air vent, remove the screws and clips.

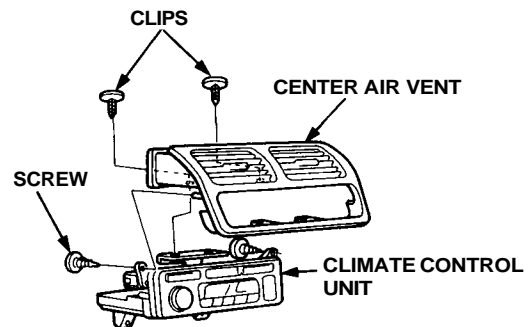



Disassemble in the numbered sequence.

Passenger's:

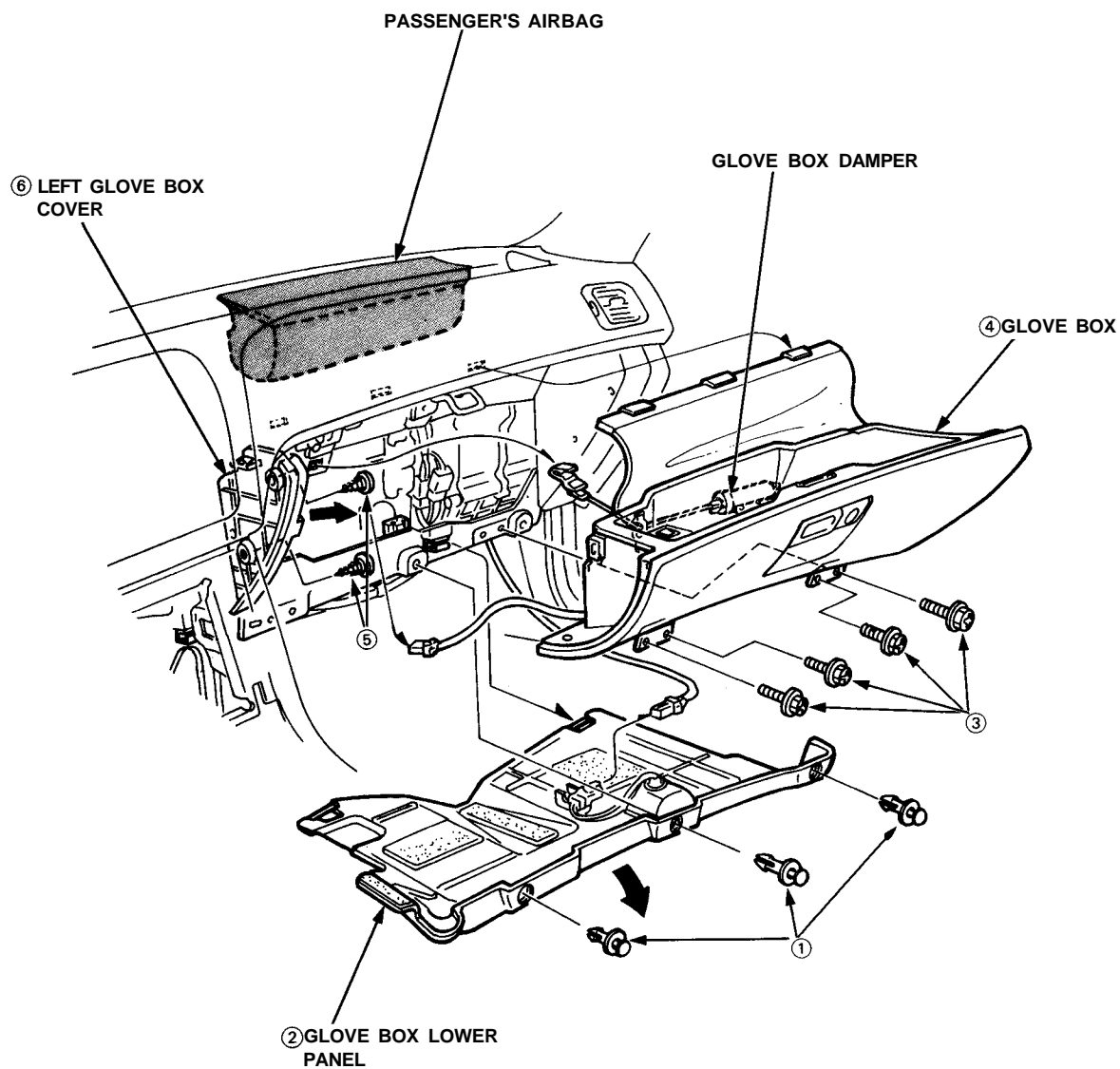

Installation is the reverse of the removal procedure.